



**BTM**   
ADVANCED TECHNOLOGY BANDSAWS



*SEMI-AUTOMATIC FIX CUT  
AP LINE*



# SEMI-AUTOMATIC TWIN-COLUMN BANDSAW MACHINES 90° FIX CUTTING



Working height  
870 mm



kg  
900  
1550  
1850

|  |     | Mod. <b>AP 350 SA F</b> | Mod. <b>AP 450 SA F</b> | Mod. <b>AP 500 SA F</b> |
|--|-----|-------------------------|-------------------------|-------------------------|
|  |     | 90°                     | 90°                     | 90°                     |
| Cutting capacities<br>mm                                 |     | 350                     | 450                     | 500                     |
|  |     | 350                     | 450                     | 500                     |
|  |     | 400 x 350               | 500 x 450               | 500 x 500               |
| BASIC<br>optional<br>Hydraulic bundle<br>clamping device |     | 400 x 185               | 500 x 235               | 500 x 260               |
|  | MAX | 400 x 350               | 500 x 450               | 500 x 500               |
| Blade dimensions   |     | 4000 x 34 x 1,1 mm      | 4580 x 34 x 1,1 mm      | 5300 x 41 x 1,3 mm      |
| Blade motor power  |     | 2,2 kW                  | 2,2 kW                  | 3 kW                    |
| Cooling pump motor power                                 |     | 0,12 kW                 | 0,12 kW                 | 0,12 kW                 |
| Hydraulic pump motor power                               |     | 0,37 kW                 | 0,37 kW                 | 0,55 kW                 |
| Chip conveyor motor power                                |     | 0,09 kW                 | 0,09 kW                 | 0,09 kW                 |
| Blade speed  |     | 20 ÷ 100 m/min          | 20 ÷ 100 m/min          | 20 ÷ 100 m/min          |
| Cutting downfeed   |     | 0 ÷ 200 mm/min          | 0 ÷ 200 mm/min          | 0 ÷ 200 mm/min          |

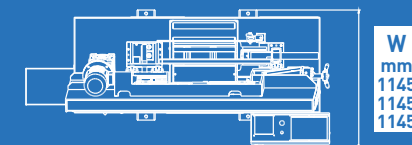
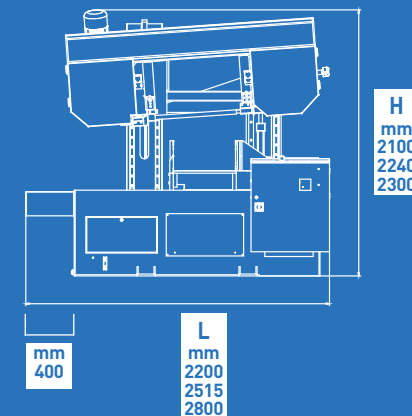

*Twin-column semiautomatic bandsaw machines, for high working performance.*

*Technical features*

- *Bow, base and columns made in welded steel structure*
- *Vertical bow descent on double ball bearing guides*
- *2° tilted bow*
- *Hydraulic blade tensioning*
- *Reducer unit with hardened and ground gears*
- *Low noise hydraulic system with variable flow*
- *Cleaning brush*
- *Inverter*
- *Chip conveyor*
- *Low voltage electrical system according to EC rules*

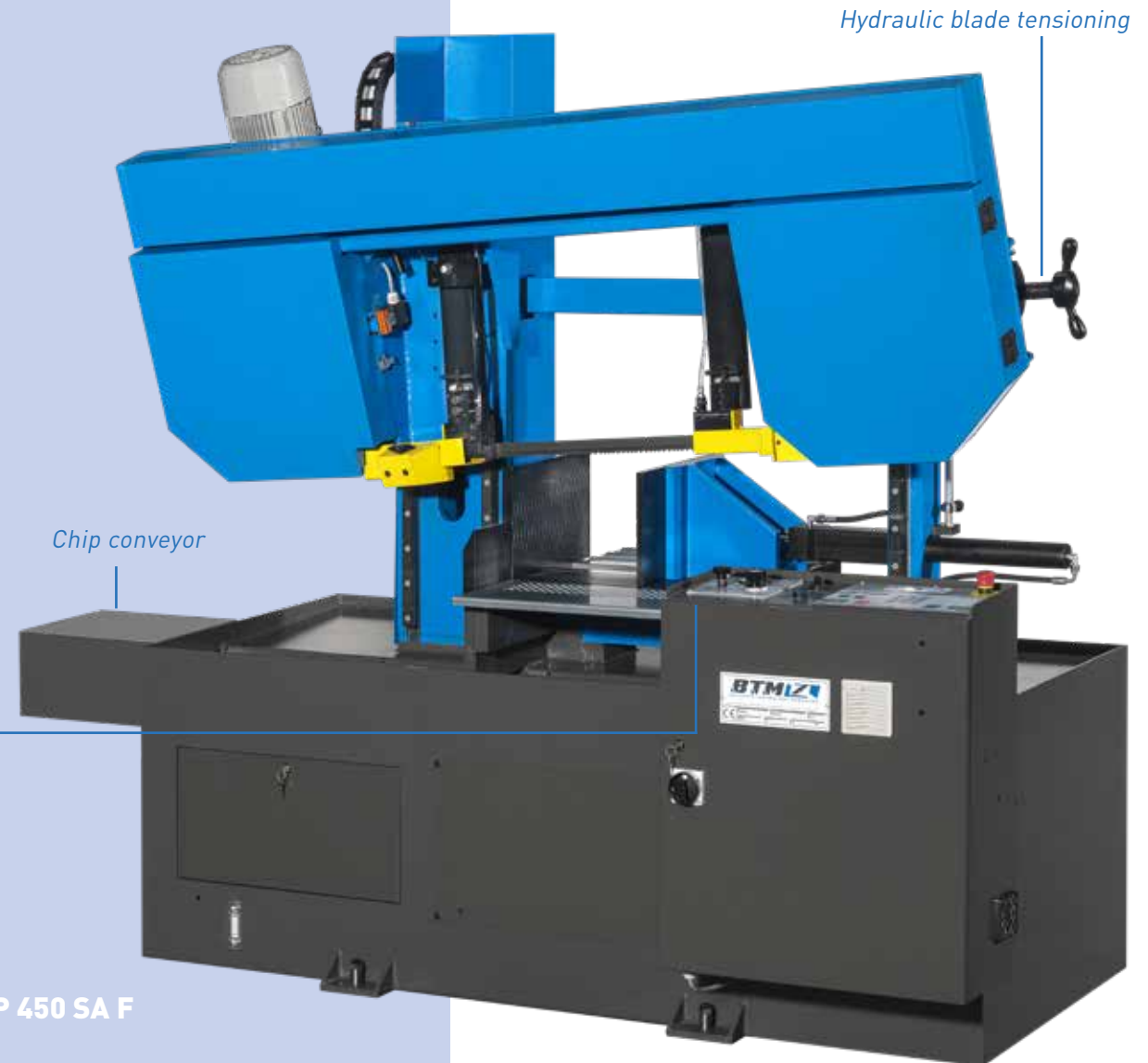

# SEMI-AUTOMATIC TWIN-COLUMN BANDSAW MACHINES 90° FIX CUTTING



Working height  
870 mm



kg  
2200  
2700  
2800

|  |     | Mod. <b>AP 7.5 SA F</b> | Mod. <b>AP 7.6 SA F</b> | Mod. <b>AP 7.7 SA F</b> |
|--|-----|-------------------------|-------------------------|-------------------------|
|  |     | 90°                     | 90°                     | 90°                     |
| Cutting capacities<br>mm                                 |     | 510                     | 610                     | 710                     |
|  |     | 510                     | 610                     | 710                     |
|  |     | 710 x 510               | 710 x 610               | 710 x 710               |
| BASIC<br>optional<br>Hydraulic bundle<br>clamping device |     | 710 x 265               | 710 x 315               | 710 x 365               |
|  | MAX | 710 x 510               | 710 x 610               | 710 x 710               |
| Blade dimensions   |     | 5800 x 41 x 1,3 mm      | 6740 x 54 x 1,6 mm      | 7450 x 54 x 1,6 mm      |
| Blade motor power  |     | 4 kW                    | 5,5 kW                  | 5,5 kW                  |
| Cooling pump motor power                                 |     | 0,12 kW                 | 0,12 kW                 | 0,4 kW                  |
| Hydraulic pump motor power                               |     | 0,75 kW                 | 1,5 kW                  | 1,5 kW                  |
| Chip conveyor motor power                                |     | 0,09 kW                 | 0,09 kW                 | 0,09 kW                 |
| Blade speed  |     | 20 ÷ 100 m/min          | 20 ÷ 100 m/min          | 20 ÷ 100 m/min          |
| Cutting downfeed   |     | 0 ÷ 200 mm/min          | 0 ÷ 200 mm/min          | 0 ÷ 200 mm/min          |

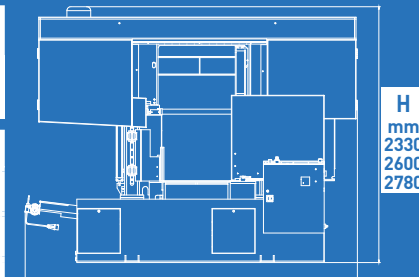

H  
mm  
2330  
2600  
2780

L  
mm  
3330  
3470  
3570

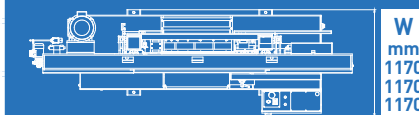

W  
mm  
1170  
1170  
1170



Twin-column semiautomatic bandsaw machines, for high working performance.

*Technical features*

- Bow, base and columns made in welded steel structure
- Vertical bow descent on ball bearing guides
- Hydraulic blade tensioning
- Reducer unit with hardened and ground gears
- Low noise hydraulic system with variable flow
- Cleaning brush
- Inverter
- Chip conveyor
- Low voltage electrical system according to EC rules

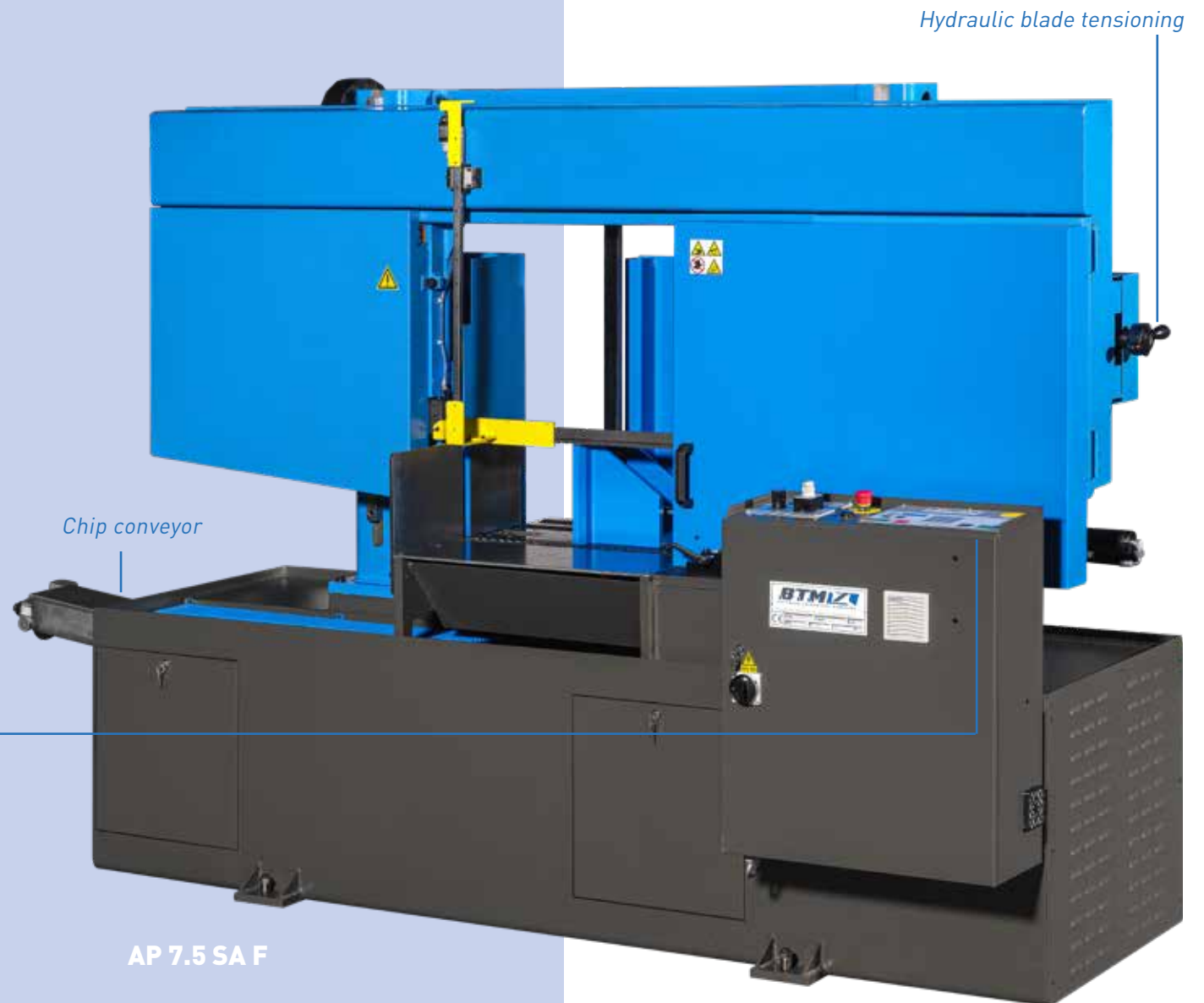

# SEMI-AUTOMATIC TWIN-COLUMN BANDSAW MACHINES 90° FIX CUTTING

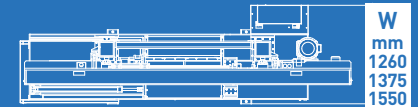
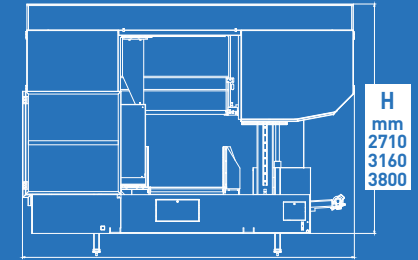

|  |     | Mod. <b>AP 8.8 SA F</b>   | Mod. <b>AP 10.1 SA F</b>  | Mod. <b>AP 12.5 SA F</b>   |
|--|-----|---------------------------|---------------------------|----------------------------|
|  |     | 90°                       | 90°                       | 90°                        |
| Cutting capacities<br>mm                                 |     | <b>810</b>                | <b>1010</b>               | <b>1250</b>                |
|  |     | <b>810</b>                | <b>1010</b>               | <b>1250</b>                |
|  |     | <b>810 x 810</b>          | <b>1010 x 1010</b>        | <b>1250 x 1250</b>         |
| BASIC<br>optional<br>Hydraulic bundle<br>clamping device |     | <b>810 x 415</b>          | <b>1010 x 515</b>         | <b>1250 x 635</b>          |
|  | MAX | <b>810 x 810</b>          | <b>1010 x 1010</b>        | <b>1250 x 1250</b>         |
| Blade dimensions   |     | <b>8900 x 54 x 1,6 mm</b> | <b>9955 x 67 x 1,6 mm</b> | <b>12500 x 67 x 1,6 mm</b> |
| Blade motor power  |     | <b>5,5 kW</b>             | <b>7,5 kW</b>             | <b>7,5 kW</b>              |
| Cooling pump motor power                                 |     | <b>0,4 kW</b>             | <b>0,4 kW</b>             | <b>0,4 kW</b>              |
| Hydraulic pump motor power                               |     | <b>1,5 kW</b>             | <b>2,2 kW</b>             | <b>2,2 kW</b>              |
| Chip conveyor motor power                                |     | <b>0,09 kW</b>            | <b>0,25kW</b>             | <b>2 x 0,25 kW</b>         |
| Blade speed  |     | <b>20 ÷ 100 m/min</b>     | <b>20 ÷ 100 m/min</b>     | <b>20 ÷ 100 m/min</b>      |
| Cutting downfeed   |     | <b>0 ÷ 200 mm/min</b>     | <b>0 ÷ 200 mm/min</b>     | <b>0 ÷ 200 mm/min</b>      |

Twin-column semiautomatic bandsaw machines, heavy construction for high working performance.

### Technical features

- Bow, base and columns made in welded steel structure
- Vertical bow descent on ball bearing guides
- Hydraulic blade tensioning
- Reducer unit with hardened and ground gears
- Low noise hydraulic system with variable flow
- Cleaning brush
- Inverter
- Chip conveyor
- Low voltage electrical system according to EC rules



Control panel  
Plc  
Touch 7"  
Touch 10"

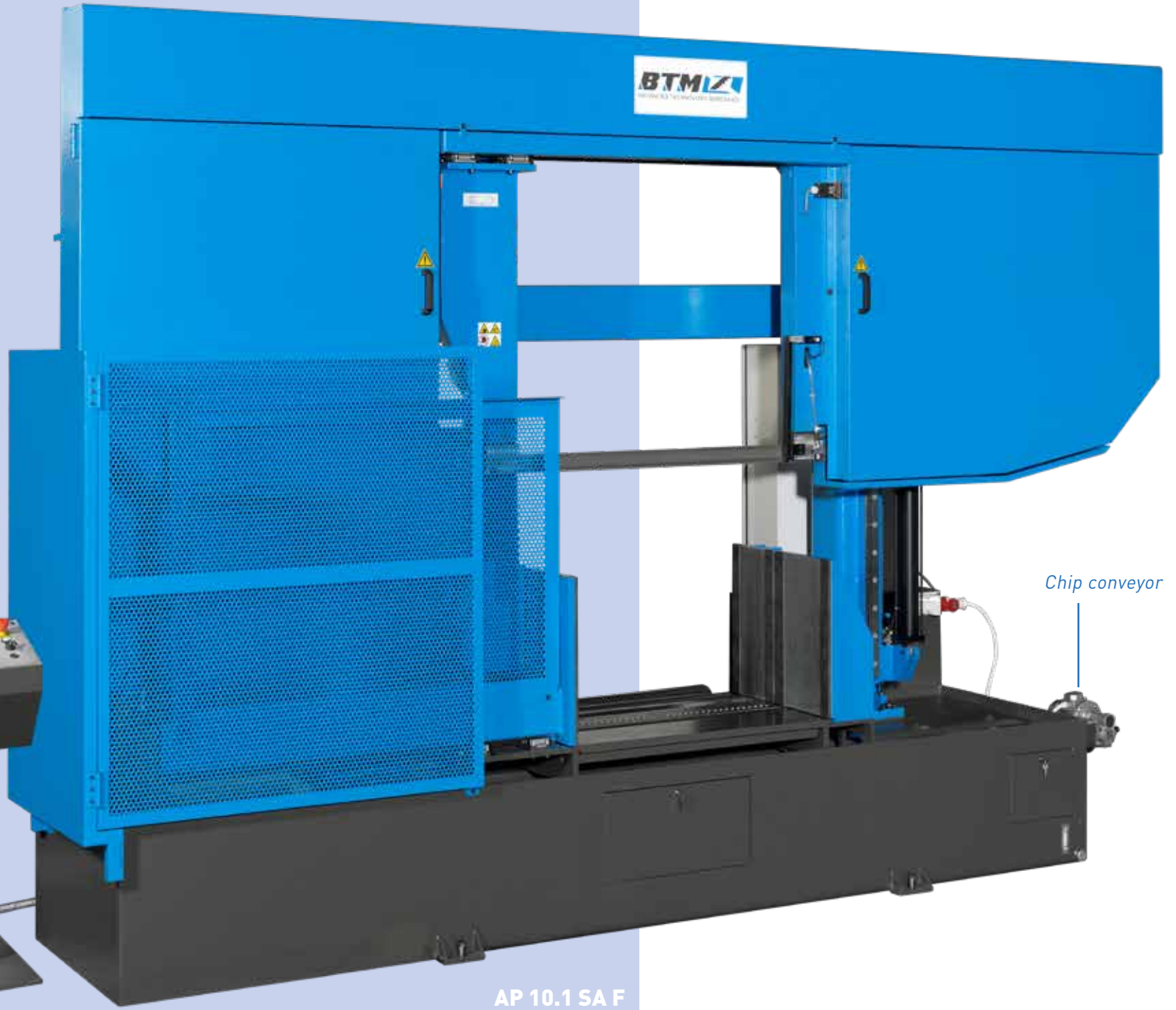

Chip conveyor

AP 10.1 SA F

## Optional accessories and roller tracks



- Powered roller
- Powered roller knurled tempered
- Piece aligner
- Adjustable vice pressure
- Blade position optical control device (laser)
- Blade deflection control device (standard on TOUCH version)
- Dry cooling device
- Hydraulic bundle clamping device BASIC
- Hydraulic bundle clamping device MAX (with vice jaws extension)
- Bow mitre rotation device
- Industry 4.0 (only for TOUCH)
- Teleservice (only for TOUCH)



Mechanical length stop with sliding on iron pipe and manual lifting



Powered length stop with sliding on iron pipe with encoder and pneumatic lifting

 1.200 kg/m

### INFEED ROLLER TRACK

Carrying capacity : 1.200 Kg/m.

With water collection tank.

Available in modules from 1 to 6 m long. Different lengths on request.

Available roller pitch : 450/250/125 mm.

Piece aligner

Powered roller track

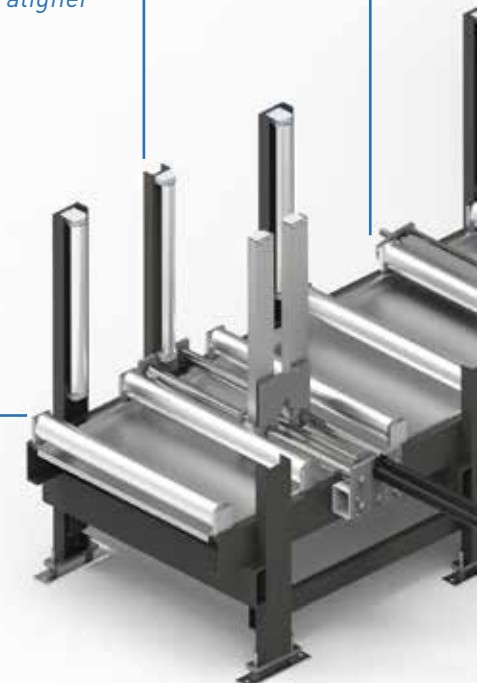



Mod AP 10.1 SA F

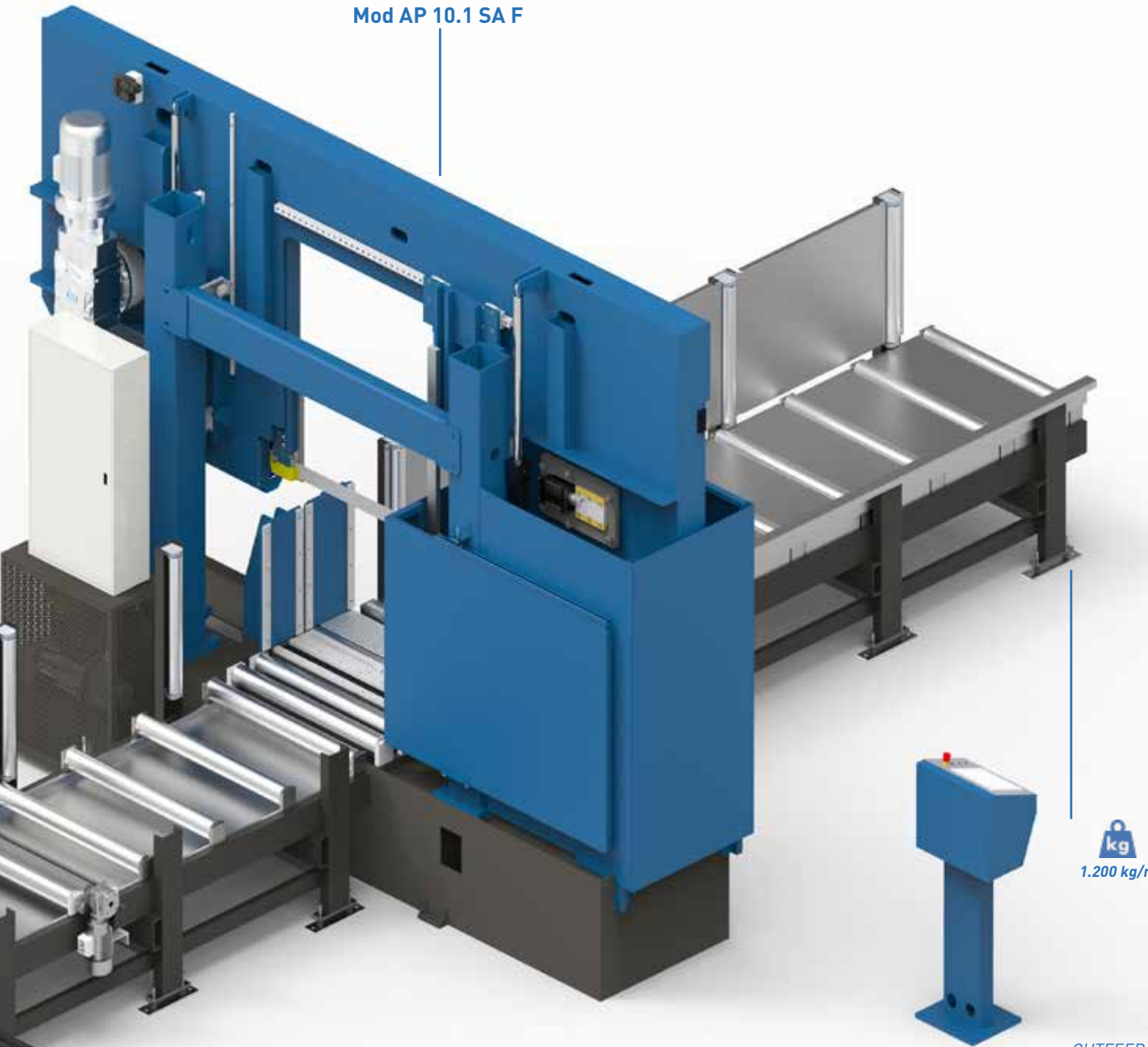

  
1.200 kg/m

**OUTFEED ROLLER TRACK**

Carrying capacity : 1.200 Kg/m.

With safety edge and water collection tank.

Available in modules from 1 to 6 m long. Different lengths on request.

The roller track can be open or closed with removable plates between rollers.

Available roller pitch : 450/250/125 mm.

OUR CUSTOM MADE SYSTEMS CLOSE TO THE NEEDS OF OUR CUSTOMERS



**1600 X 230 SA Touch** Semiautomatic bandsaw machine at high working performances, ideal for cutting any type of material including strong and hard metals like titanium, hastelloy, inconel.



**AP 8.8 SA F** paper coils  $\varnothing$  800 cutting system



AP 10.1 SA F



Since 1982



facchinetti@forlani.com 07/21



*BTM since the early 80s is the leader in the design and production of special and oversized bandsaw machines, to satisfy the special needs of the customers who want a reliable, safe and custom-made product.*

*The final result is a custom machine developed by the close co-operation between BTM and its customers. The design engineering, production, assembly, and the final machine testing are all performed by highly skilled personnel at btm's plants, following the "MADE IN ITALY" philosophy.*

Btm Srl reserves the right at any time and without advance notice to introduce modifications to the present catalogue. The images and data in this catalogue must be considered for you for reference only.